

**visicolor**® ECO Chlordioxid

Chlorine dioxide / Dioxyde de chlore / Cloro dióxido

| Method(e) / Método                   | PF-3 Pool /<br>Drinking Water<br>530 nm | PF-12<br>540 nm | PF-12 <sup>Plus</sup><br>540 nm | Advance<br>530 nm |
|--------------------------------------|---|-----------------|---------------------------------|-------------------|
| 5211 0.20–3.80 mg/L ClO <sub>2</sub> |   | ■               | ■                               | ■                 |
| 5211 0.10–3.80 mg/L ClO <sub>2</sub> | ■                                       |                 |                                 |                   |

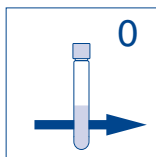

Null mit Probe  
Blank with sample  
Blanc avec échantillon  
En blanco con muestra

Nicht geeignet für Meerwasser  
Not suitable for seawater  
Ne convient pas à l'eau de mer  
No es adecuado para el agua de mar

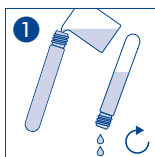

Küvetten spülen  
Rinse test tube  
Rincer les éprouvettes  
Lavar los tubos

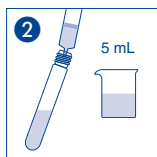

Probe  
Sample  
Echantillon  
Muestra

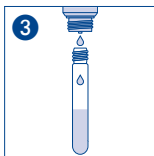

2  $\Delta$  ClO<sub>2</sub>-1

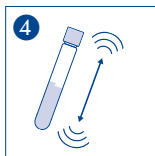

Schütteln  
Shake  
Agiter  
Agitar

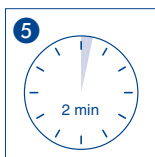

Warten  
Wait  
Attendre  
Espere

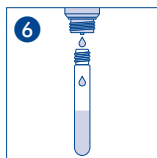

3  $\Delta$  ClO<sub>2</sub>-2

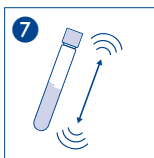

Schütteln  
Shake  
Agiter  
Agitar

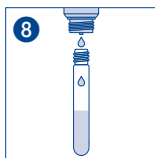

3  $\Delta$  ClO<sub>2</sub>-3

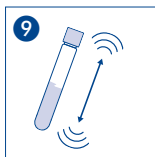

Schütteln  
Shake  
Agiter  
Agitar

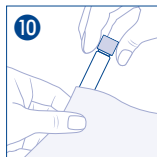

Säubern  
Clean  
Nettoyer  
Limpiar

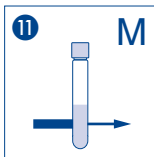

Messung  
Measurement  
Mesure  
Medición